

**NOTE:**  
FOR ADDITIONAL PAVEMENT MARKING DETAILS  
SEE IDOT DISTRICT 1 STANDARD TC-11.

**PAVEMENT MARKING LEGEND**

- |  |   |  |
|--|---|--|
| ① THERMOPLASTIC PAVEMENT MARKING - LETTERS AND SYMBOLS (78000100)                            | ⑦ THERMOPLASTIC PAVEMENT MARKING - LINE 6" SKIP-DASH WHITE, 6' SKIP - 2' DASH (78000400)  | ⑫ EPOXY PAVEMENT MARKING - LINE 4" SOLID WHITE (78005110)          |
| ② THERMOPLASTIC PAVEMENT MARKING - LINE 4" SOLID WHITE (78000200)                            | ⑧ THERMOPLASTIC PAVEMENT MARKING - LINE 6" SKIP-DASH YELLOW, 6' SKIP - 2' DASH (78000400) | ⑬ EPOXY PAVEMENT MARKING - LINE 6" SOLID WHITE (78005130)          |
| ③ THERMOPLASTIC PAVEMENT MARKING - LINE 4" SOLID YELLOW (78000200)                           | ⑨ THERMOPLASTIC PAVEMENT MARKING - LINE 12" SOLID WHITE (78000600)                        | ⑭ EPOXY PAVEMENT MARKING - LINE 24" SOLID WHITE (78005180)         |
| ④ THERMOPLASTIC PAVEMENT MARKING - LINE 4" SKIP- DASH, WHITE, 30" SKIP - 10" DASH (78000200) | ⑩ THERMOPLASTIC PAVEMENT MARKING - LINE 12" SOLID YELLOW (78000600) AT 30" CENTERS        | ⑮ RECESSED REFLECTIVE PAVEMENT MARKER (ONE-WAY CRYSTAL) (X7810300) |
| ⑤ THERMOPLASTIC PAVEMENT MARKING - LINE 4" SOLID DUAL YELLOW, 11" SPACING C-C (78000200)     | ⑪ THERMOPLASTIC PAVEMENT MARKING - LINE 24" SOLID WHITE (78000650)                        | ⑯ RECESSED REFLECTIVE PAVEMENT MARKER (TWO-WAY AMBER) (X7810300)   |
| ⑥ THERMOPLASTIC PAVEMENT MARKING - LINE 6" SOLID WHITE (78000400)                            |   | ⑰ EPOXY PAVEMENT MARKING - LINE 12" SOLID WHITE (78005150)         |
|  |   | ➔ DIRECTION OF TRAVEL  |

4662\_E08\_SCI.tbl  
 E08\_EDWA\_PDF.plt  
 03690  
 6/8/2016  
 PLOT SCALE = 100.00' / in. FILENAME = 4662\_GLB\_ahL\_SignPmk-04.dgn

DRAWN BY JDW DATE 1/12/16  
 CHECKED BY RCH DATE 1/12/16



**THE ILLINOIS STATE TOLL HIGHWAY AUTHORITY**  
 2700 OGDEN AVENUE  
 DOWNERS GROVE, ILLINOIS 60515

REVISIONS		
NO.	DATE	DESCRIPTION
①	06/08/2016	ISSUE NO. 1

CONTRACT NO. I-15-4662  
 PAVEMENT MARKING  
 AND SIGNING PLAN  
 YORK ROAD

SHEET NO.  
 PMK-4  
 DRAWING NO.  
 287 OF 655

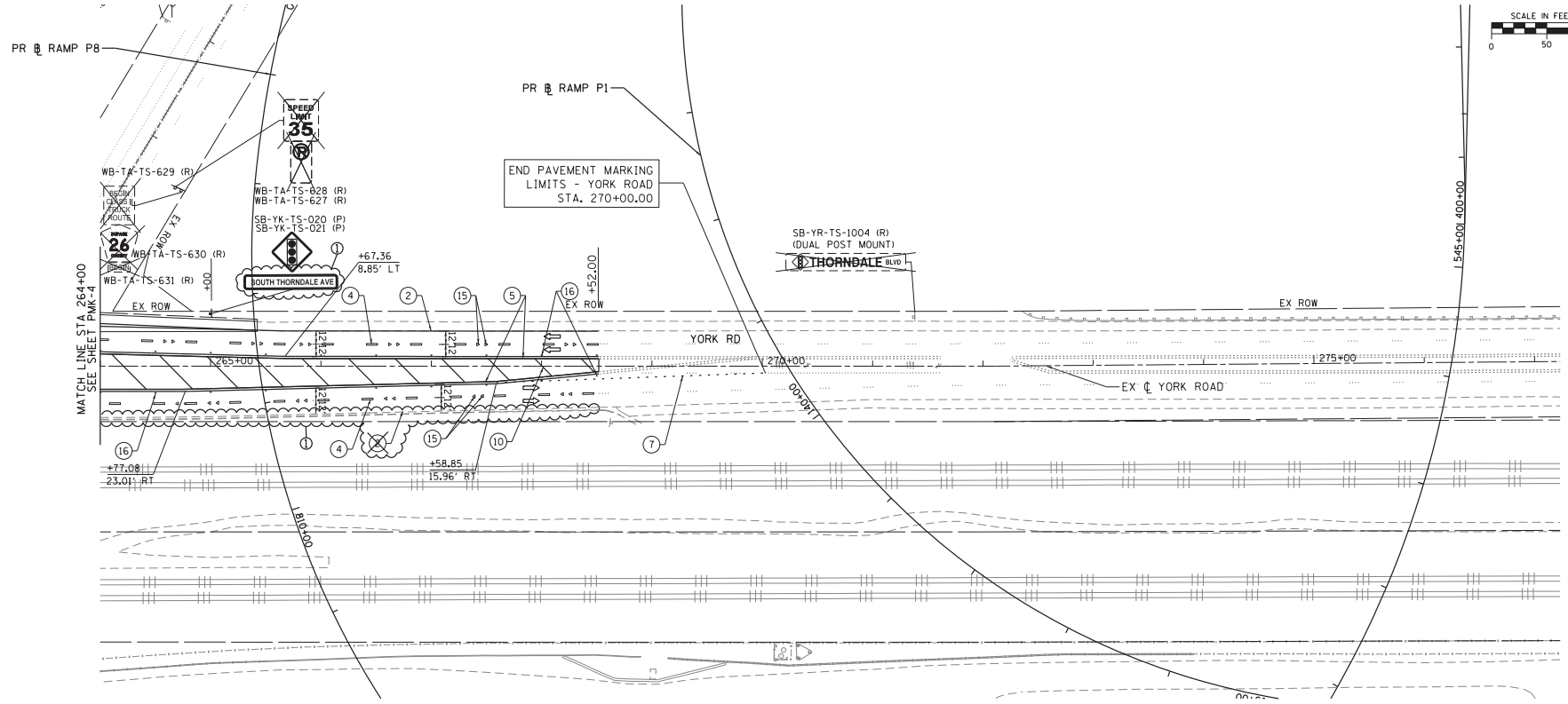
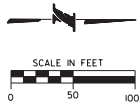

END PAVEMENT MARKING  
LIMITS - YORK ROAD  
STA. 270+00.00

NOTE:  
FOR ADDITIONAL PAVEMENT MARKING DETAILS  
SEE IDOT DISTRICT 1 STANDARD TC-11.

PAVEMENT MARKING LEGEND

- ① THERMOPLASTIC PAVEMENT MARKING - LETTERS AND SYMBOLS (78000100)
- ② THERMOPLASTIC PAVEMENT MARKING - LINE 4" SOLID WHITE (78000200)
- ③ THERMOPLASTIC PAVEMENT MARKING - LINE 4" SOLID YELLOW (78000200)
- ④ THERMOPLASTIC PAVEMENT MARKING - LINE 4" SKIP- DASH, WHITE, 30" SKIP - 10" DASH (78000200)
- ⑤ THERMOPLASTIC PAVEMENT MARKING - LINE 4" SOLID DUAL YELLOW, 11" SPACING C-C (78000200)
- ⑥ THERMOPLASTIC PAVEMENT MARKING - LINE 6" SOLID WHITE (78000400)
- ⑦ THERMOPLASTIC PAVEMENT MARKING - LINE 6" SKIP-DASH WHITE, 6' SKIP - 2' DASH (78000400)
- ⑧ THERMOPLASTIC PAVEMENT MARKING - LINE 6" SKIP-DASH YELLOW, 6' SKIP - 2' DASH (78000400)
- ⑨ THERMOPLASTIC PAVEMENT MARKING - LINE 12" SOLID WHITE (78000600)
- ⑩ THERMOPLASTIC PAVEMENT MARKING - LINE 12" SOLID YELLOW (78000600) AT 30" CENTERS
- ⑪ THERMOPLASTIC PAVEMENT MARKING - LINE 24" SOLID WHITE (78000650)
- ⑫ EPOXY PAVEMENT MARKING - LINE 4" SOLID WHITE (78000510)
- ⑬ EPOXY PAVEMENT MARKING - LINE 6" SOLID WHITE (78000510)
- ⑭ EPOXY PAVEMENT MARKING - LINE 24" SOLID WHITE (78000510)
- ⑮ RECESSED REFLECTIVE PAVEMENT MARKER (ONE-WAY CRYSTAL) (X7810300)
- ⑯ RECESSED REFLECTIVE PAVEMENT MARKER (TWO-WAY AMBER) (X7810300)
- ⑰ EPOXY PAVEMENT MARKING - LINE 12" SOLID WHITE (78000510)



4622\_E08\_SCI.tbl  
 E08\_EDWA\_PDF.plt.dgn  
 03690  
 6/8/2016  
 PLOT SCALE = 100.00' / in.  
 FILENAME = 4662\_GLB\_ahL\_SignPmk-05.dgn

DRAWN BY JDW DATE 1/12/16  
 CHECKED BY RCH DATE 1/12/16



**THE ILLINOIS STATE TOLL HIGHWAY AUTHORITY**  
 2700 OGDEN AVENUE  
 DOWNERS GROVE, ILLINOIS 60515

REVISIONS	
NO.	DESCRIPTION
①	06/08/2016 ISSUE NO. 1

CONTRACT NO. I-15-4662  
 PAVEMENT MARKING  
 AND SIGNAGE PLAN  
 YORK ROAD

SHEET NO.  
 PMK-5  
 DRAWING NO.  
 288 OF 655